

---

# Self-help Guide - Wi-Fi Connection (POLITE-CET)

## Contents

<b>Purpose of this guide</b> .....	1
<b>Things to take note before you begin</b> .....	1
<b>1 - Connecting to POLITE-CET</b> .....	2
<b>2 - Connecting to POLITE-CET (on iOS and Android devices)</b> .....	4
2.1 For iOS device.....	4
2.2 For Android device.....	6

## Purpose of this guide

- This guide shall assist you for successful connection to POLITE-CET Wi-Fi in campus.
- If you are having connectivity issues with POLITE-CET, you may use this guide to fix them.
- By performing the steps provided in this guide, you can resolve your Wi-Fi connectivity issue within few minutes and avoid queuing at IT Helpdesk.

## Things to take note before you begin

- ✓ You must be in campus to be able to detect this Wi-Fi.
- ✓ Make sure your Wi-Fi is enabled and able to connect any Wi-Fi.
- ✓ During this setup, the ethernet cable should be disconnected.
- ✓ This whole process will take approximately 5 to 10 minutes.

## 1 - Connecting to POLITE-CET

1.1 Click on **"POLITE-CET"** > **"Connect"**.

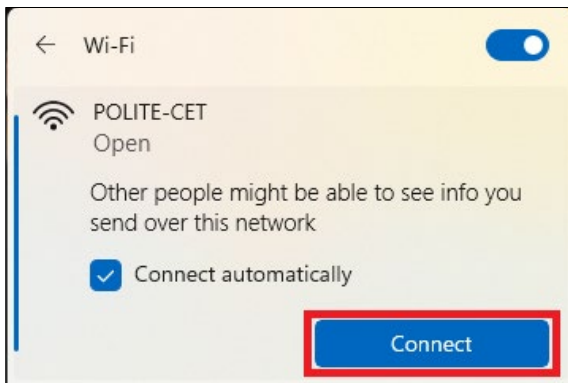

1.2 Your default web browser will launch a login page for sign-in using your Student ID.  
Enter your Student ID > click **"Sign in"**.

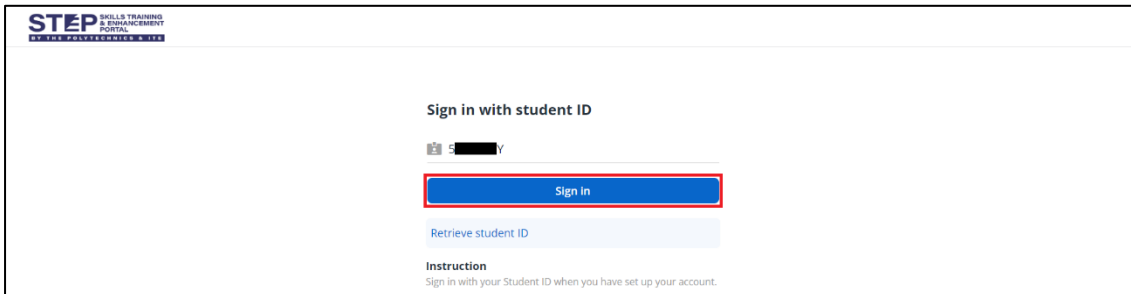

1.3 Enter your password > click **"Sign in"**.

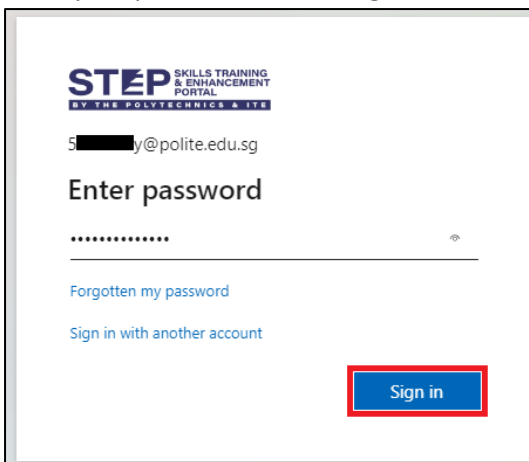

1.4 Verify your identity via 2FA that was previously set up.

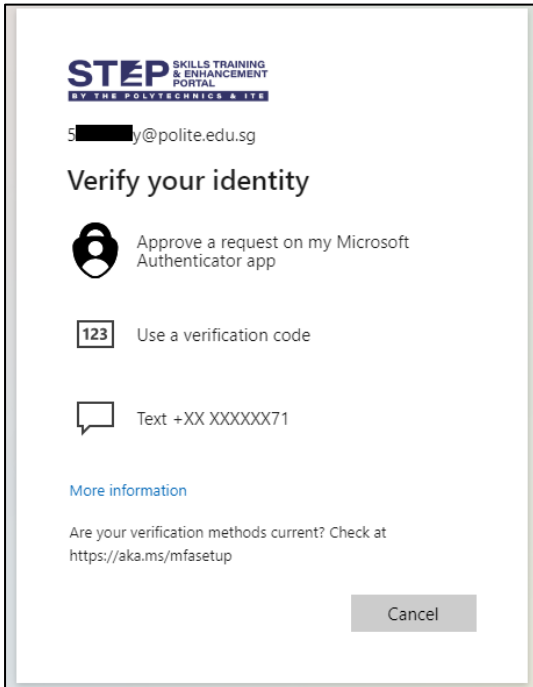

1.5 Once logged in successfully, it will redirect to the <https://step.polite.edu.sg> webpage.



## 2 - Connecting to POLITE-CET (on iOS and Android devices)

### 2.1 For iOS device

#### 2.1.1 Go to **Settings > Wi-Fi > tap on "POLITE-CET"**.

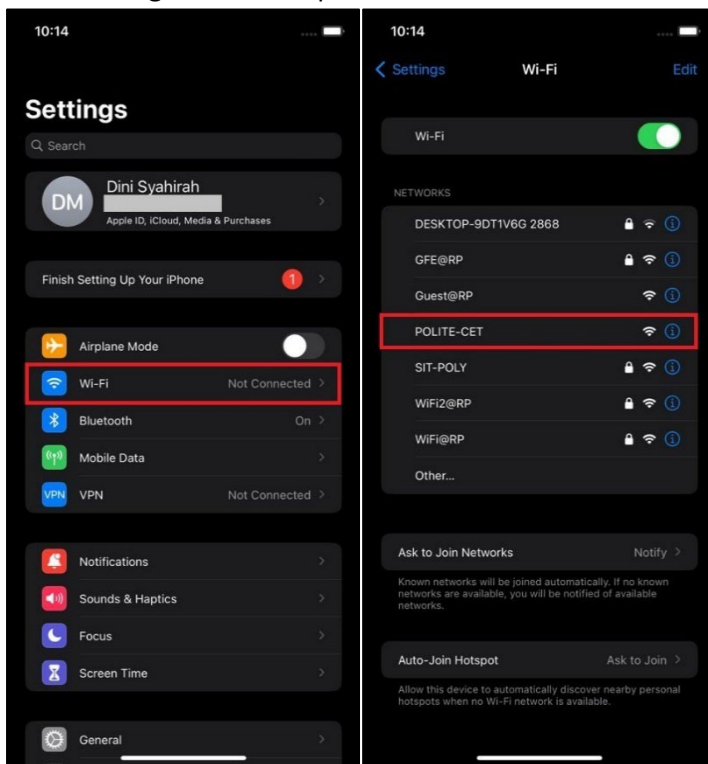

#### 2.1.2 It will launch a login page for sign-in using your Student ID. Enter your Student ID and click **"Sign in"**.



2.1.3 Enter your password > click “Sign in” .

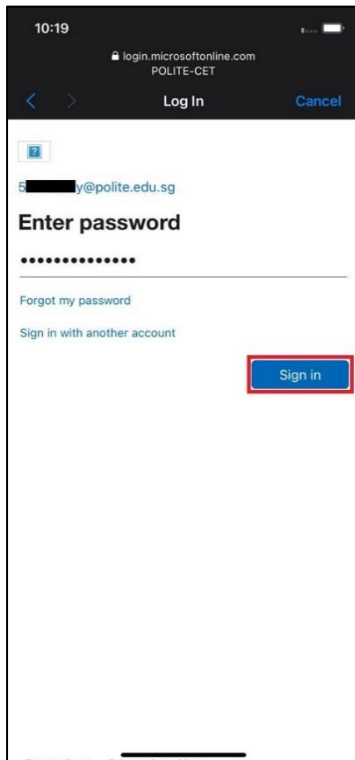

2.1.4 Verify your identity via 2FA that was previously set up.



2.1.5 Ensure it's connected to **POLITE-CET** successfully.

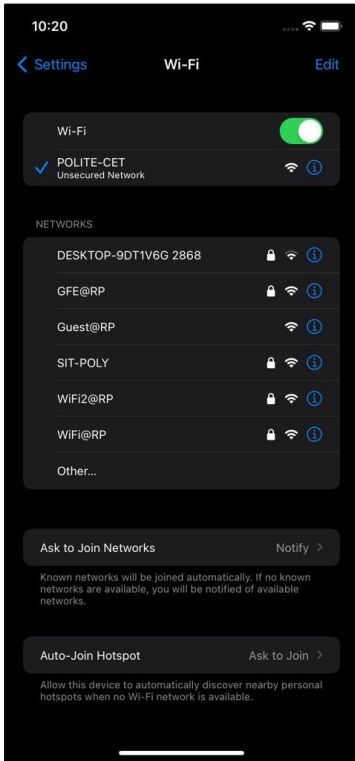

2.2 For Android device

2.2.1 Go to **Settings > Connections > Wi-Fi > tap on "POLITE-CET"**.

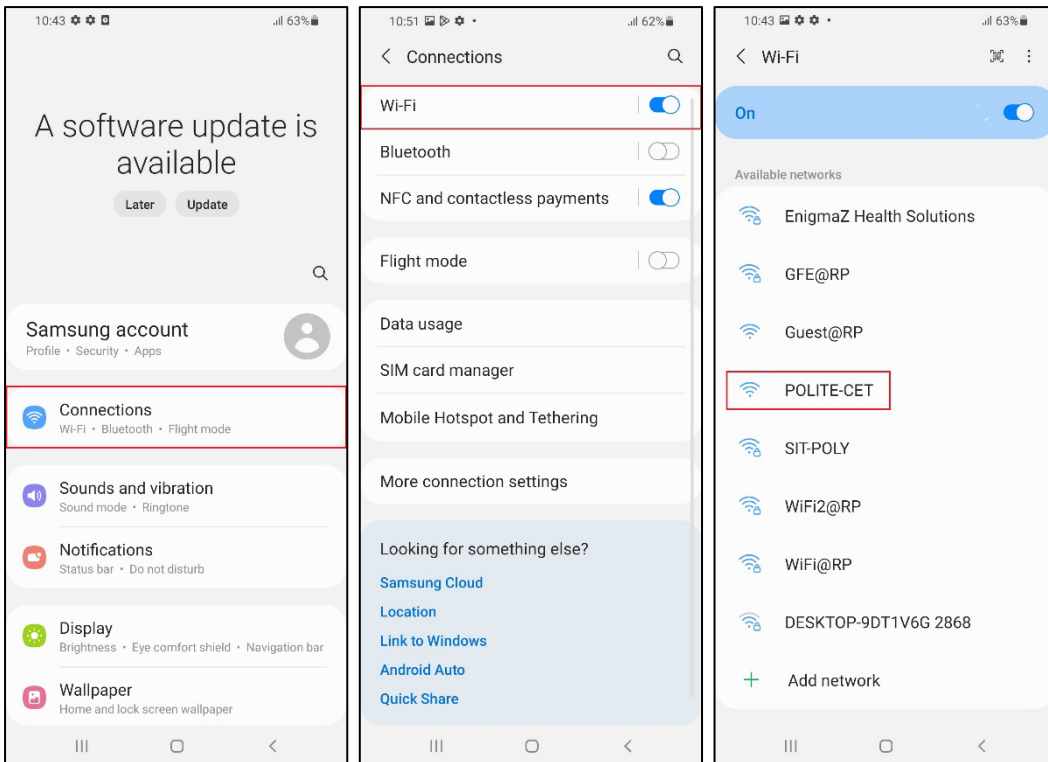

2.2.2 Tap on **“Sign in to the network”** (or alternatively you may open the sign-in site from the notifications).

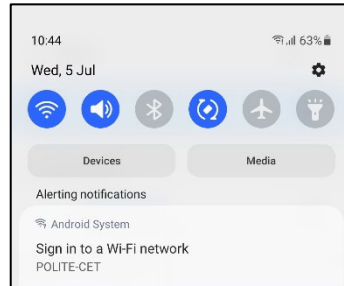
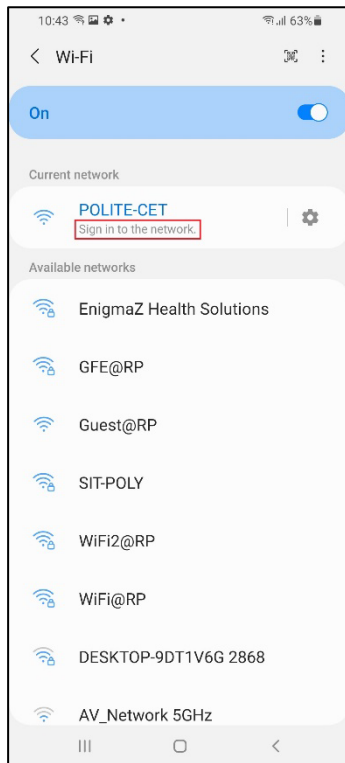

2.2.3 It will launch a login page for sign-in using your Student ID. Enter your Student ID > click **“Sign in”**.

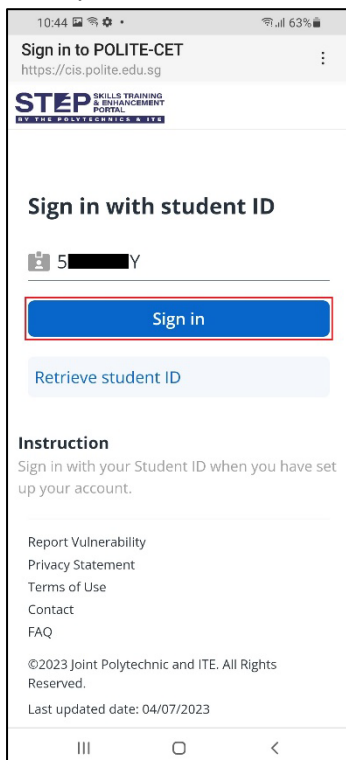

2.2.4 Enter your password > click “Sign in”.

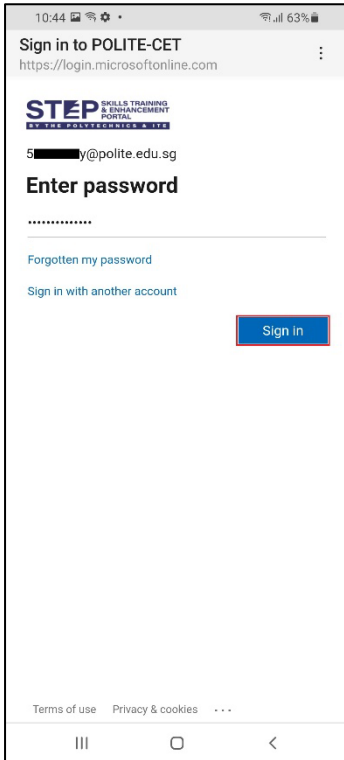

2.2.5 Verify your identity via 2FA that was previously set up.

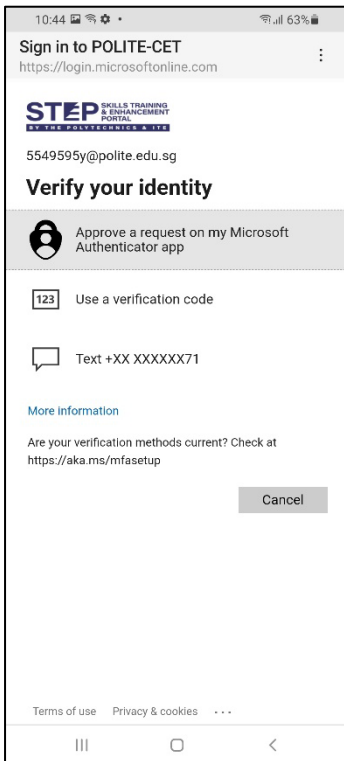



2.2.6 Ensure it's connected to **POLITE-CET** successfully.

